

TOWN OF LOMIRA

T.13N., R.17E.

AERIAL MAP INDICATOR

6	5	4	3	2	1
7	8	9	10	11	12
13	14	15	16	17	18
19	20	21	22	23	24
25	26	27	28	29	30
31	32	33	34	35	36

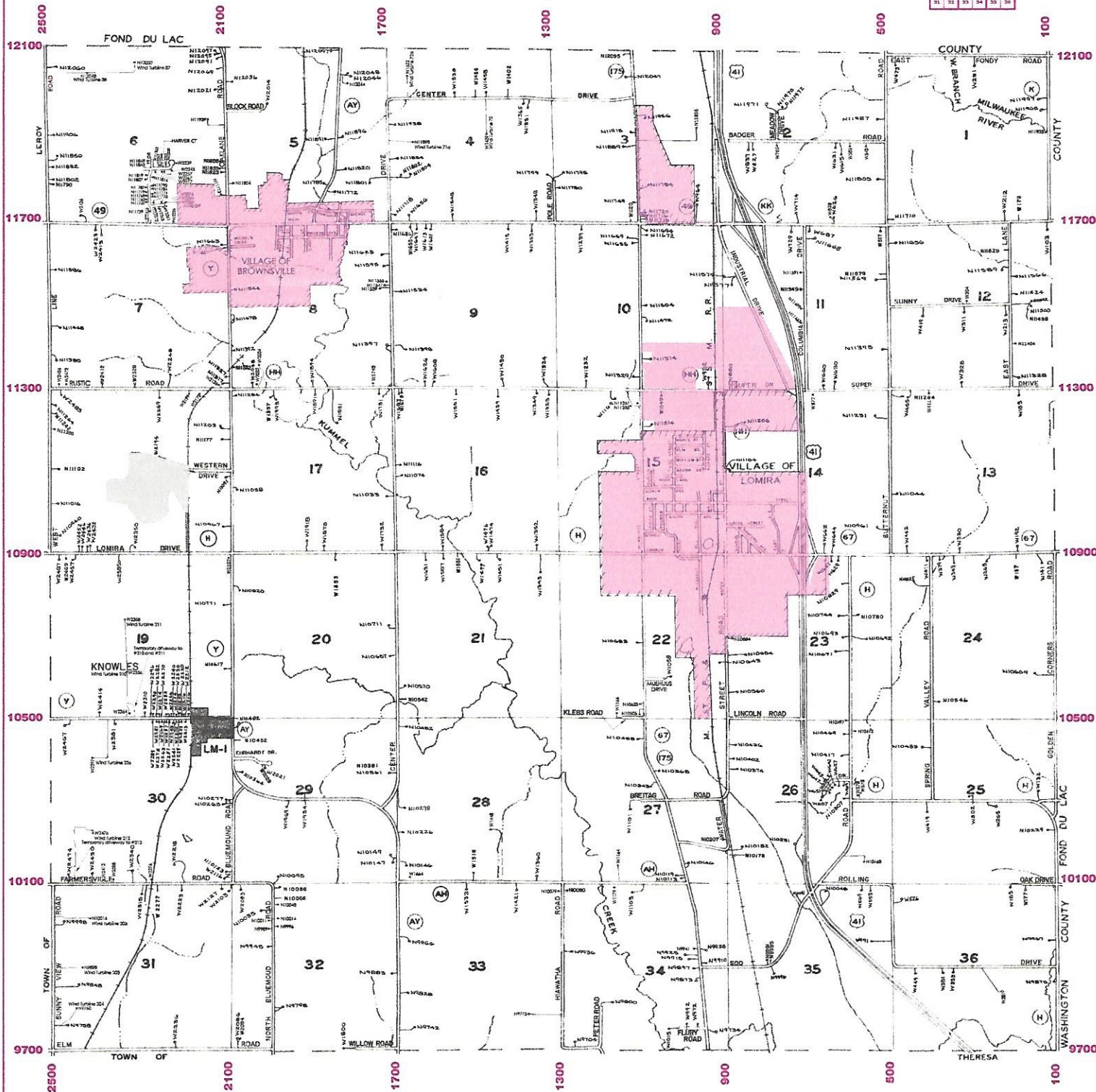

BUILDING NUMBERS UPDATED AS ASSIGNED

DODGE COUNTY
LAND RESOURCES AND PARKS
DEPARTMENT

BUILDING NUMBERING SYSTEM

